

# SEACHROME

SEACHROME CORPORATION

Phone: (800) 955-2476

Fax: (800) 444-3380

www.seachrome.com

Description:

**SCAL-157P-W**

Locking Recessed Partition Combo

Toilet Seat Cover Dispenser

Sanitary Napkin Disposal

Toilet Tissue Dispenser

Womens

Customer:

Customer Part #

06-19-2012

This drawing and the information contained herein is proprietary to Seachrome Corp. and shall not be reproduced, copied or disclosed in whole, or part, or used for manufacturing or for any other purpose without the written permission of Seachrome Corporation.

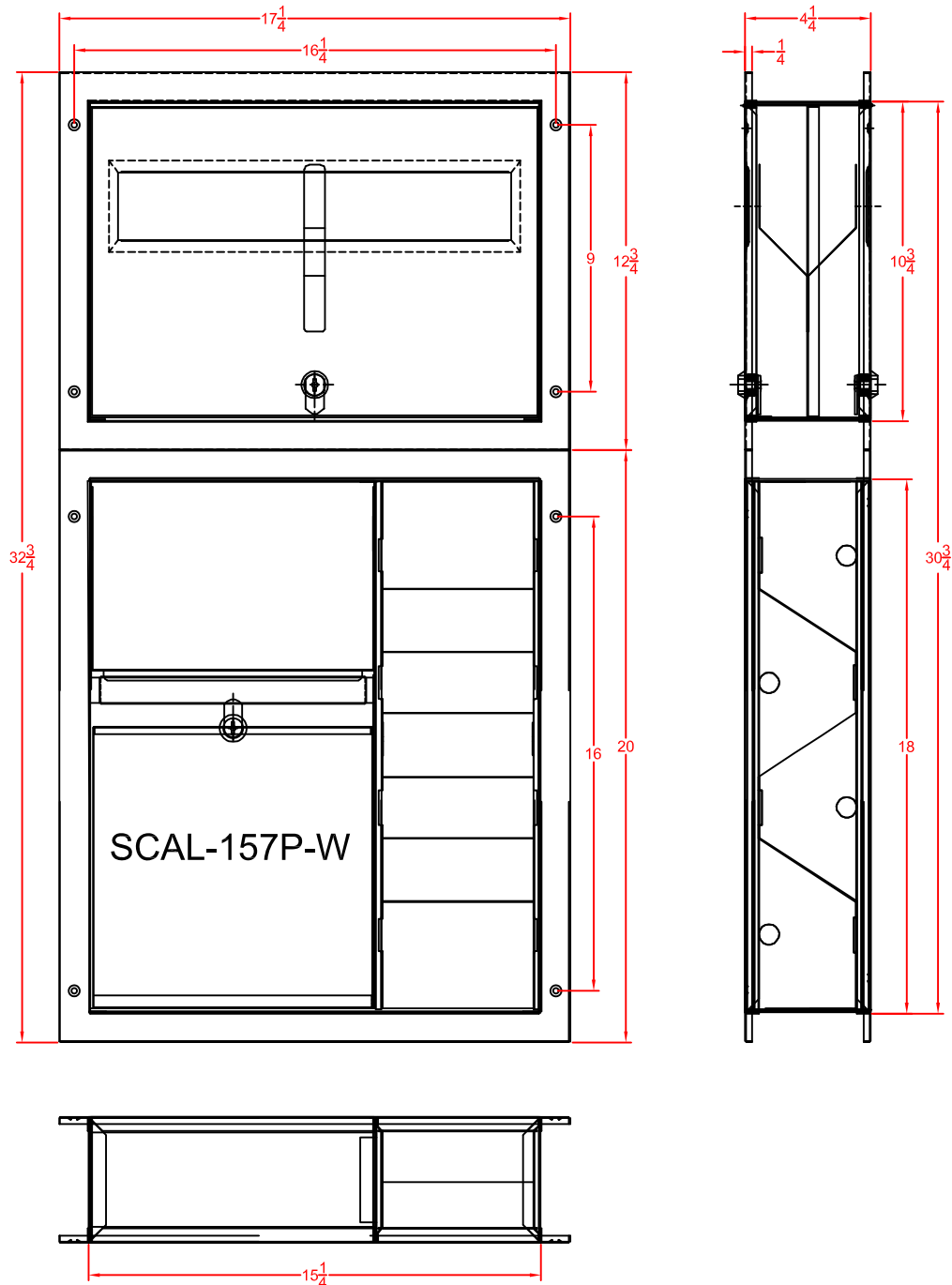

#304 Satin Stainless Steel

Overall: 17-1/4" Wide x 32-3/4" High x 4-1/4" Deep.

Wall Opening: 15-3/4" Wide x 31-3/16" High x 4" Deep

Capacity: 500 Seat Covers, 2 Rolls Toilet Tissue

This information is subject to change without formal notice. If you need assistance, please contact Seachrome Corporation's technical support staff.

# SEACHROME

SEACHROME CORPORATION

Phone: (800) 955-2476

Fax: (800) 444-3380

www.seachrome.com

Description:

**SCAL-157P-W**

Locking Recessed Partition Combo

Toilet Seat Cover Dispenser

Sanitary Napkin Disposal

Toilet Tissue Dispenser

Womens

Customer:

Customer Part #

06-19-2012

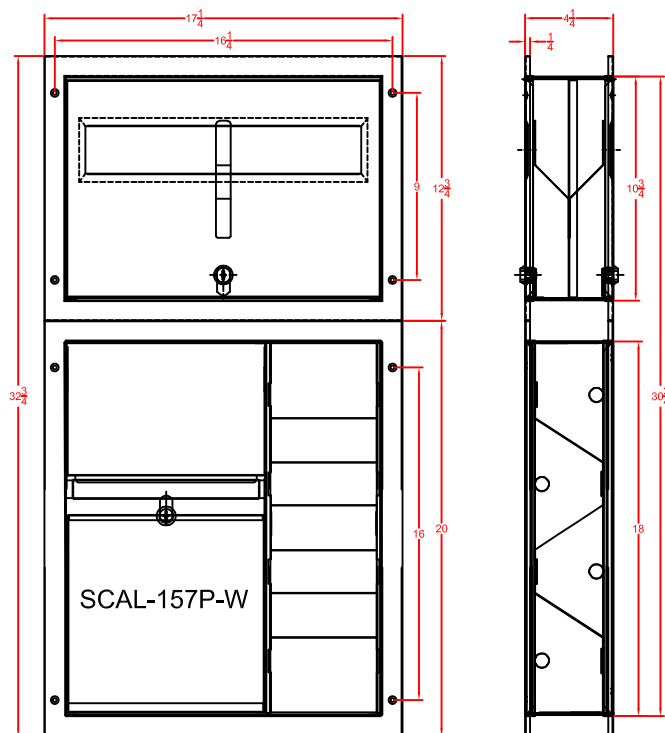

## Specifications:

### DETAILS:

Recessed combination toilet seat cover dispenser, waste receptacle and dual roll tissue dispenser is fabricated of stainless steel with exposed surfaces in satin finish. The cabinet door is constructed of 22 gauge stainless steel with full length hinge and secured with keyed lock. Removable 2 gallon waste receptacle.

**OPERATION:** Front of cabinet door hinged for easy servicing of unit.

**OVERALL SIZE:** 17-1/4"W x 32-3/4"H x 4-1/4"D

**CAPACITY:** 500 Seat Covers. 2 Rolls Toilet Tissue

**ADA COMPLIANT:** Consult local and national codes for proper installation guidelines.

## Installation:

Provide an area on mounting surface at desired or specified location. Requires rough wall opening 15-3/4" W x 31-3/16" H x 4" D. Secure unit with screws (included) to framing at mounting hole locations.

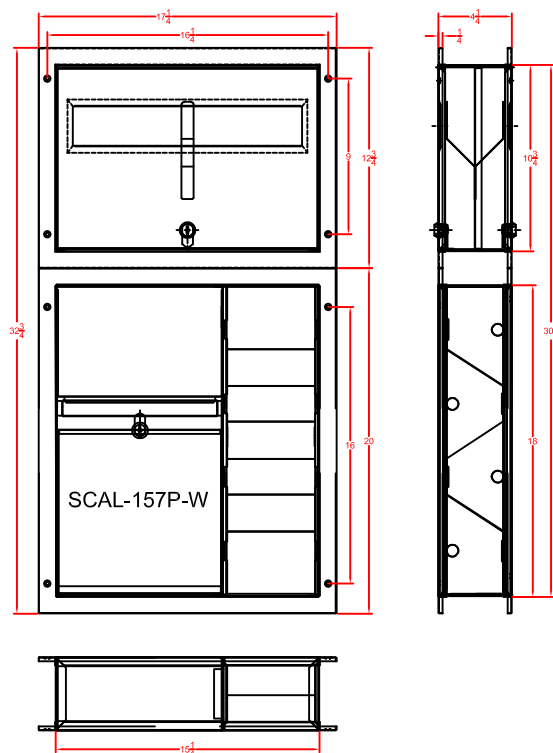

This drawing and the information contained herein is proprietary to Seachrome Corp. and shall not be reproduced, copied or disclosed in whole, or part, or used for manufacturing or for any other purpose without the written permission of Seachrome Corporation.

This information is subject to change without formal notice. If you need assistance, please contact Seachrome Corporation's technical support staff.