

SEACHROME

SEACHROME CORPORATION

Phone: (800) 955-2476

Fax: (800) 444-3380

www.seachrome.com

Description:

SCAL-159R

Locking Recessed Paper
Towel Dispenser

Customer:

Customer Part #

05-29-2012

This drawing and the information contained herein is proprietary to Seachrome Corp. and shall not be reproduced, copied or disclosed in whole, or part, or used for manufacturing or for any other purpose without the written permission of Seachrome Corporation.

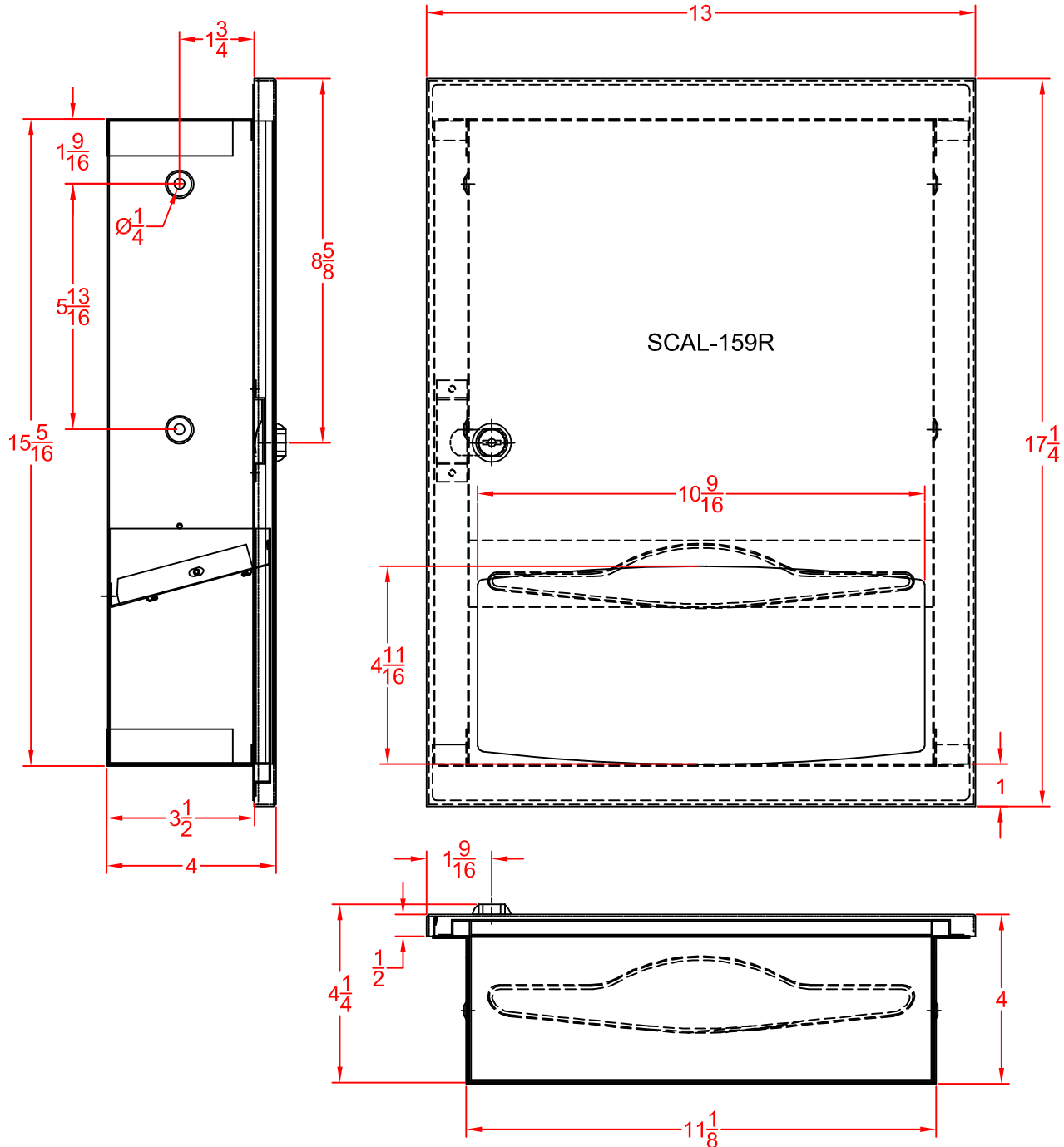

#304 Satin Stainless Steel

Overall: 13" Wide x $17\frac{1}{4}$ " High x $4\frac{1}{4}$ " Deep.

Wall Opening: $11\frac{1}{4}$ " Wide x $15\frac{1}{2}$ " High x $3\frac{3}{4}$ " Deep

Capacity: 350 C-Fold / 475 Multi-Fold Paper Towels

This information is subject to change without formal notice. If you need assistance, please contact Seachrome Corporation's technical support staff.

SEACHROME

SEACHROME CORPORATION

Phone: (800) 955-2476

Fax: (800) 444-3380

www.seachrome.com

Description:

SCAL-159R Locking Recessed Paper Towel Dispenser

Customer:

Customer Part #

05-29-2012

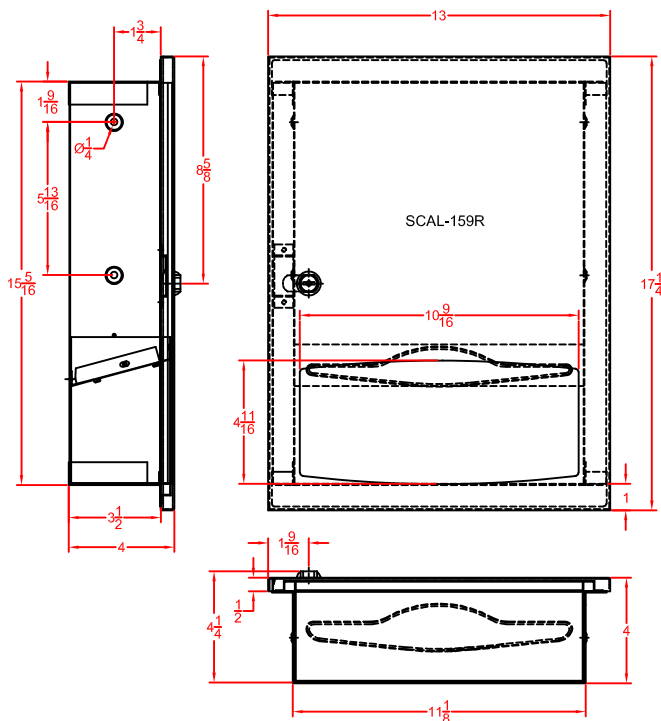

Specifications:

DETAILS:

Recessed towel dispenser is fabricated of heavy gauge stainless steel with exposed surfaces in satin finish. The cabinet door is constructed of 18 gauge stainless steel with full length hinge along side and secured with keyed lock.

OPERATION: Towel dispenser holds multi-fold or C-fold towels without use of special adapter.

OVERALL SIZE: 13"W x 17-1/4"H x 4-1/4" D

CAPACITY: 350 C-Fold / 475 Multi-Fold Paper Towels.

ADA COMPLIANT: Consult local and national codes for proper installation guidelines.

This drawing and the information contained herein is proprietary to Seachrome Corp. and shall not be reproduced, copied or disclosed in whole, or part, or used for manufacturing or for any other purpose without the written permission of Seachrome Corporation.

Installation:

Provide an area on mounting surface at desired or specified location. Requires rough wall opening 11-1/4"W x 15-1/2"H x 3-3/4" D. Secure unit to framing with screws (included) at mounting hole locations.

